

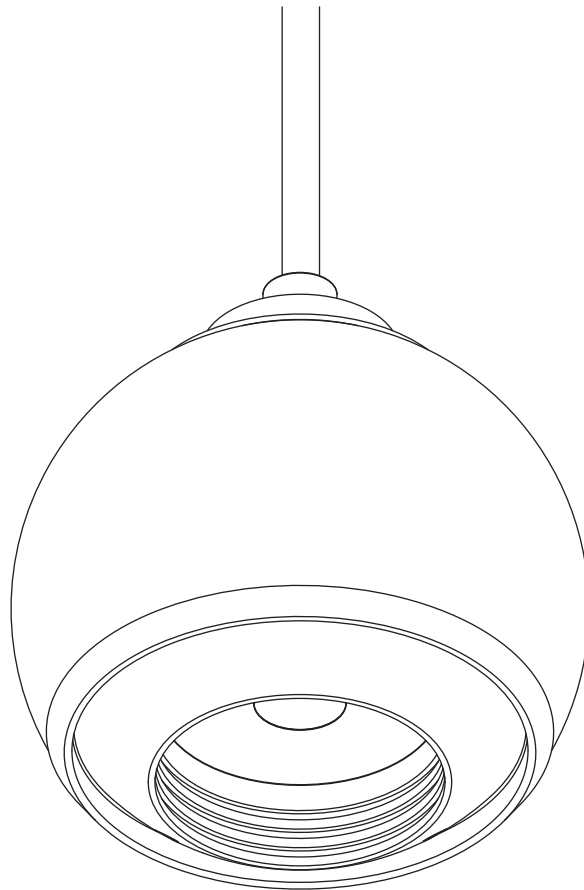

# Gallo Pendant

## Installation and Maintenance Instructions



**IMPORTANT: All wiring connections must be made before switching on mains power.**

 MSL Type L 9.9V<sub>F</sub> 10.4W @ 1050mA

 This product should not be disposed of in your general waste

 Please retain these instructions for future reference

 Class III - Extra Low Voltage

**IP20** Indoor Use Only

 European Conformity

Stoane Lighting Ltd  
20 Dryden Road Bilston Glen Ind Est.  
Loanhead Midlothian EH20 9LZ UK

T: +44 (0) 131 440 1313  
F: +44 (0) 131 440 0049  
sales@mikestoanelighting.com

www.stoanelighting.com  
VAT No GB682885284  
Limited Company 188910

## Electrical Supply

Installation must be carried out by a qualified electrician in accordance with BS 7671:2008 Wiring Regulations. 230/240V AC 50/60Hz mains supply to a suitable SELV LED Driver.

Site conditions: LED equipment is more susceptible to static damage and over voltage than previous technology. Before handling or connecting to the mains supply ensure that all MSL products are protected from static discharge and that the mains supply is to regulation. (230V +10 -6%)

Mains cables must be double insulated, strain relieved and separated from E.L.V output cables.

**This unit requires a constant current driver. 1050mA Max.**

**Observe polarity:  
Positive (+) is marked as RED.  
Incorrect supply or reverse polarity can cause irreparable damage.**

**All connections must be made before switching on mains.** If the supply is energised prior to making the connections to the fitting then the resulting surge will damage the LED.

Multiple LEDs should be wired in series, refer to driver instructions for minimum/maximum load.

All lighting equipment is delicate and easily damaged through misuse or inappropriate installation (mechanical or electrical). Repairs and replacements may cause delays and will be chargeable. Contact SL for support if required. For full warranty terms & conditions please visit our website.

The light source contained in this luminaire shall only be replaced by the manufacturer or his service agent or a similar qualified person.

The entire dimming control circuit source must be of SELV insulation class.

If the external flexible cord of this luminaire is damaged, it shall be exclusively replaced by the manufacturer or his service agent or similar qualified person in order to avoid a hazard.

Maximum permissible ambient temperature is 35°C. For fittings used beyond this temperature please contact Stoane Lighting.

## Installation

Check that the mounting surface is suitable for the installation of this fitting.

A suitable hole is required for the incoming supply cable.

- Step 1 Secure the mount plate to the mounting surface.
- Step 2 Route the cable up through the cord grip and cap as shown on the mount plate. Set the drop height by tightening the cord grip with the cable at the required length.
- Step 3 Make mains connections to SELV LED driver and extra low voltage connections to the fitting.
- Step 4 Secure the cap to the mount plate with the supplied button fixings.

All suspended installations should be inspected by a competent person at least once a year

**WARNING: Do not look at exposed LED lamps in operation. Eye injury can result.**

Additional items should not be hung or suspended from this fitting. SL takes no responsibility for additional items added by others or the consequences of those items.

## Cleaning:

Fully isolate the fitting and allow to cool.

Clean the fitting with a slightly damp lint free cloth from a mild solution of soap and water. The fitting must be completely dry before reconnecting power.

Incompatible or abrasive chemicals can damage the fitting, contact SL for advice if required.

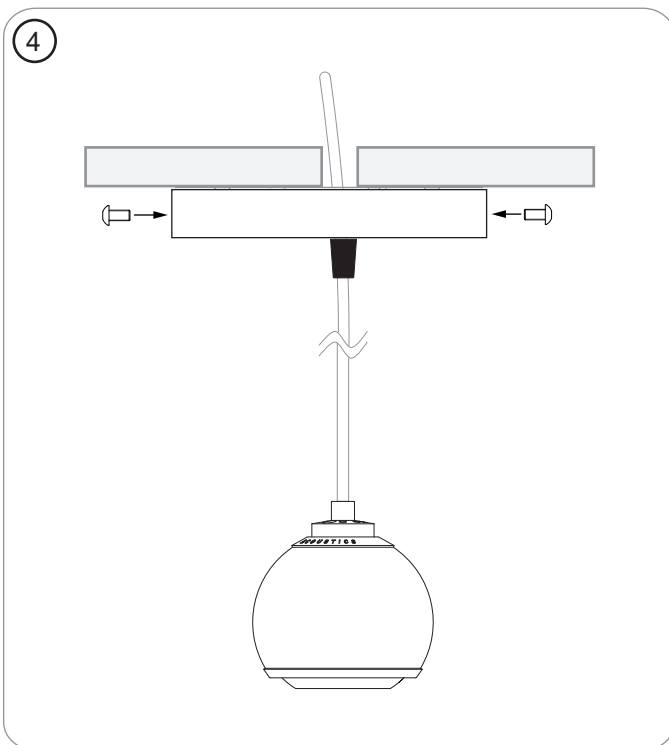
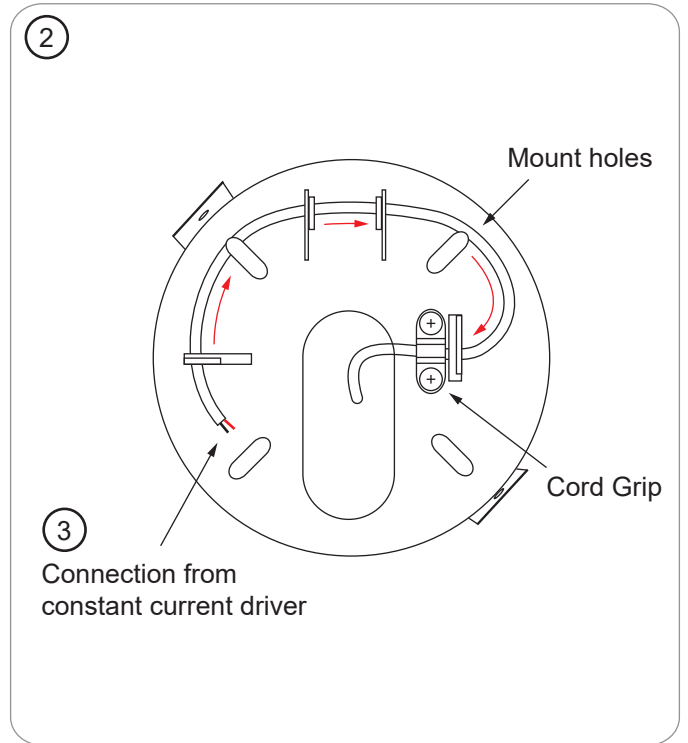
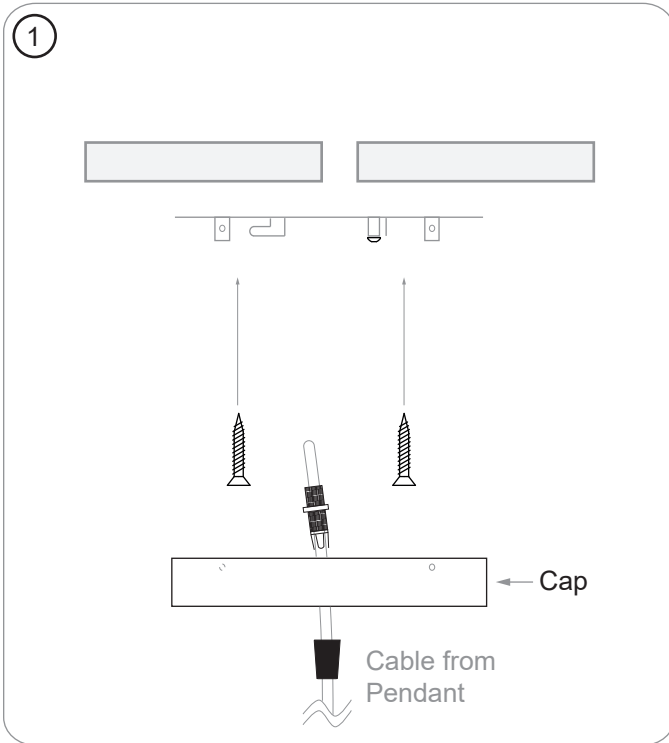

**Recommended Driver Options**

This fitting requires a constant current supply of 1050mA. A lower drive current can be used but the light output of the fitting will drop.

While any constant voltage driver which has an output voltage range which meets 9.9Vf at 1050mA and can take the Wattage (10.4W) can be used, we recommend the following drivers.

Fulham L05016i (use one driver per fitting).

EldoLed Solodrive or Ecodrive. (20W version will run a single fitting while the 30W version will run up to two fittings in series).

For larger installations it is recommended you contact Gallo/Stoane Lighting for advice if required.

## Series Wiring

### SUPPLY

Installation must be carried out by a qualified electrician in accordance with BS 7671:2008 Wiring Regulations.  
230/240V AC 50/60Hz mains supply.

Mains cables must be double insulated and strain relieved.

Observe polarity:  
Positive (+) is marked as RED.  
Incorrect supply or reverse polarity can cause irreparable damage.

All connections must be made before switching on mains.

Ensure supply driver and connectors are housed indoors OR in a suitable IP rated enclosure.

Ensure LEDs are connected in 'series' as shown below to the LED drivers.

