



## Prepare for the 8K Theater Revolution

High-spec HDMI® unlocks exciting features for gamers and film lovers in your family, including 8K video passthrough, HDR10+, and low-latency gameplay. Enjoy DTS:X® and Dolby Atmos® 3D soundtracks with refined Integra power and convenient voice-controllable multi-room audio.

### AUDIO & VIDEO HIGHLIGHTS

- 5.2.2-ch Dolby Atmos® and DTS:X® playback
- DTS Virtual:X™ and Dolby Atmos Height Virtualization
- Dolby Surround® and DTS® Neural:X upmixing
- HDMI®<sup>1</sup> supports 8K/60p (4:4:4/12-bit<sup>2</sup>, 4:2:2/12-bit<sup>2</sup>, 4:2:0/10-bit), 8K/30p (4:4:4/12-bit<sup>2</sup>, 4:4:4/10-bit, 4:2:2/12-bit), 4K/120p (4:4:4/12-bit<sup>2</sup>, 4:4:4/10-bit, 4:2:2/12-bit) video passthrough, HDR10+, Dolby Vision™, HDR10, HLG, BT.2020, VRR (Variable Refresh Rate), DSC (Display Stream Compression), ALLM (Auto Low Latency Mode), QFT (Quick Frame Transport), QMS (Quick Media Switching), eARC (enhanced Audio Return Channel), DeepColor™, x.v.Color™, LipSync, and HDCP 2.3
- HDMI Main Out with eARC for encoded HQ audio, Sub/Zone 2 Out with OSD<sup>3</sup>
- Bidirectional Bluetooth® wireless technology Version 4.2 + LE (A2DP v1.2, AVRCP v1.3; RX: SBC/AAC, TX: SBC/Qualcomm® aptX™/apt X HD)
- Separate Zone 2 speaker outputs enable 5.2.2-ch + Zone 2 speaker connection, 5.2.2-ch playback switching to 5.2-ch + Zone 2 playback<sup>4</sup>
- Dedicated Zone 2 DAC supports synced/independent D/A audio distribution (including HDMI/SPDIF/NET<sup>5</sup>) via Zone 2 speaker outputs and Zone 2 pre-out<sup>6</sup>
- Share any MAIN audio source to a wireless headphone dock via Zone B line-out<sup>6</sup>
- Phono equalizer (MM) and SACD (Super Audio CD) playback via HDMI (2.8 MHz 2-ch/multichannel)
- AccuEQ Room Calibration with subwoofer EQ and AccuReflex™
- Original DSP-based Vocal Enhancer clarifies in-program vocals/dialog

### AMPLIFICATION TECHNOLOGY

- 80 W per channel (8 ohms, 20 Hz–20 kHz, 0.08% THD, 2-ch driven, FTC)
- Low-impedance amp system with 4-ohm speaker-driving capability
- Massive custom transformer and hand-selected audio parts
- Non-phase-shift amp-circuit topology for clear and cohesive sound
- Optimum Gain Volume Circuitry
- Precision DAC supports 192 kHz/24-bit multichannel D/A conversion
- VLSC™ (Vector Linear Shaping Circuitry) filtering technology (Front L/R)
- PLL (Phase-Locked Loop) jitter-cleaning circuitry for SPDIF digital audio
- Front L/R speaker bi-amping capability in 5.2-ch configuration
- Tone controls (bass/treble) for Front L/R channels

### NETWORK & MULTI-ZONE AUDIO FEATURES

- Isolated quad-core SoC board supports high-speed 802.11ac (2x2 MIMO<sup>7</sup>) Wi-Fi®
- Supports Amazon Music HD<sup>8</sup>, Spotify®, TIDAL, TuneIn, Pandora®, and Deezer<sup>9</sup>
- Works with Sonos supporting multiple Sonos Connect/Port control and Volume Passthrough mode<sup>10</sup>
- Works with Alexa supporting multi-room music<sup>11</sup>
- Works with Hey Google<sup>12</sup> and Chromecast built-in™
- AirPlay 2 multi-room audio with Siri voice control
- DTS Play-Fi®<sup>13</sup> multi-room audio via Integra Music Control App<sup>14</sup>
- Compatible with the Integra Remote app for iPad®, iPhone®, and Android™<sup>14</sup>
- Roon Tested certified for the Roon Core
- Hi-Res Audio via network (DSD 11.2 MHz/5.6 MHz/2.8 MHz<sup>15</sup>, FLAC, WAV [RIFF], ALAC, and AIFF to 192 kHz/24-bit<sup>16</sup>)

### AUDIO-VIDEO CONNECTIONS

- 6 HDMI inputs, Main Out (eARC), Sub/Zone 2 Out
- 2 digital audio inputs (rear, 1 optical, 1 gold-plated coaxial, assignable)
- 4 gold-plated analog RCA audio inputs (rear, assignable)
- Gold-plated phono input and built-in equalizer (MM) for turntable connection
- USB input (5 V/1 A) for audio playback (rear)
- Gold-plated 1/8" (3.5 mm) AccuEQ setup mic input (front)
- Gold-plated 1/4" (6.35 mm) headphone jack
- 9 gold-plated banana-plug-ready speaker posts with transparent knobs (including Zone 2)
- Dedicated gold-plated Zone 2 speaker outputs<sup>4</sup>
- Gold-plated Front L/R pre-out, Zone 2 pre-out, and Zone B line-out (analog RCA<sup>6</sup>)
- 2 subwoofer pre-outs
- Ethernet LAN terminal

### CUSTOM INTEGRATION FEATURES

- 10BASE-T/100BASE-TX Ethernet supports setup and IP control via web browser
- Works with Crestron®, Control4®, Savant, URC, ELAN, and RTI automation
- RS-232 input for external control and automation
- 2 IR inputs and 1 output
- 3 programmable 12 V trigger-outs with adjustable delay (A: 100 mA, B: 25 mA, C: 25 mA)
- Dealer-settings memory storage and recall function
- AC inlet for detachable IEC power cable
- Optional rack-mount kit (IRK-155-3D)

### ADDITIONAL FEATURES

- Aluminum front panel and volume knob
- One-touch volume memory preset assignment to individual A/V inputs via front panel
- OSD function displays A/V input signal data, output signal/settings data, and network information
- Dolby® TrueHD and DTS-HD Master Audio® decoding
- Advanced Music Optimizer™ improves compressed audio playback quality
- High-definition GUI over HDMI
- 4K to 8K, 1080p to 8K/4K video upscaling via HDMI
- Crossover Adjustment (40/45/50/55/60/70/80/90/100/110/120/130/150/180/200 Hz)
- A/V Sync Control (Up to 500 ms in 1 ms steps at 48 kHz<sup>17</sup>)
- Sleep timer, HDMI passthrough, and network standby
- 40 FM/AM/internet radio presets with station-naming (10 characters)
- 3-Mode display dimmer (Normal/Dim/Dimmer)

<sup>1</sup> Features defined in HDMI 2.1 specification, HDR10+, and passthrough capabilities described are supported on HDMI inputs 1–3, Main Out, and Sub/Zone 2 Out in Sub Mode output. <sup>2</sup> DSC signals only. <sup>3</sup> HDMI Zone 2 Mode output supports signals via HDMI inputs 1–3. <sup>4</sup> Playback via Height (5.2.2-ch layout) or Surround Back (7.2-ch layout) speaker outputs is unavailable when playing in 5.2-ch + Zone 2 speaker output mode. Output via Zone 2 speaker output and Zone 2 pre-out enabled. <sup>5</sup> Zone 2 HDMI audio is available on inputs 1–3. SPDIF and HDMI support PCM signals only. <sup>6</sup> Zone 2 pre-out, Zone B line-out, and Front L/R pre-out are exclusive modes shared on the same analog RCA output. <sup>7</sup> Some countries or regions have regulations that affect wireless signal strength and the use of Wi-Fi channels. <sup>8</sup> Amazon Music HD is supported via DTS Play-Fi. <sup>9</sup> Service availability varies with region, and a paid subscription may be required. <sup>10</sup> Requires Sonos Connect or Port (sold separately). Connection of 1–2 Sonos devices is supported with volume control enabled via the Sonos app. Sonos app available free for compatible iPhone® and iPad® at the App Store. Available free for compatible Android™ devices at the Google Play Store. <sup>11</sup> Voice control requires an Amazon Alexa enabled device. Alexa multi-room music may require a firmware update. <sup>12</sup> Voice control requires a Google Assistant enabled device. <sup>13</sup> Enabled with a future firmware update. <sup>14</sup> Available free for compatible iPhone, iPad, and Android devices. <sup>15</sup> Converted to PCM. Playback not guaranteed via wireless LAN. <sup>16</sup> Supported sampling rates may vary depending on network environment. ALAC is supported to a maximum 96 kHz. <sup>17</sup> Max. 400 ms (1 ms steps) at 96 kHz, and max. 200 ms (1 ms steps) at 192 kHz.

## 7.2-CHANNEL NETWORK A/V RECEIVER

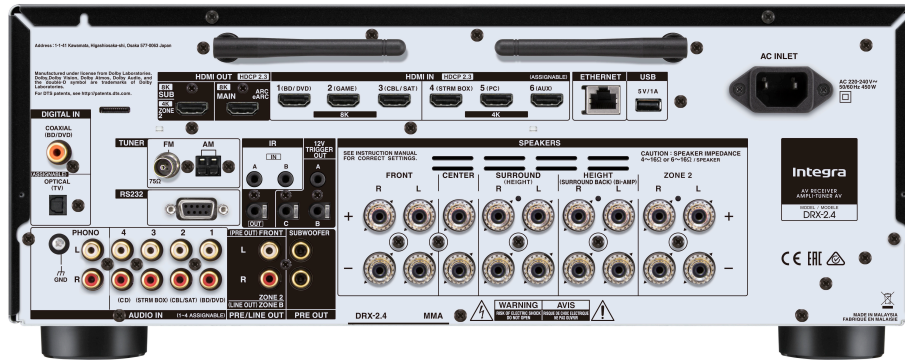

- 8K4K**
- HDR10+**
- COMPATIBLE WITH
- Dolby Vision**
- Dolby Atmos**
- dts X**
- deezer**
- TIDAL**
- Spotify**
- pandora**
- amazon music**



### SPECIFICATIONS

#### AMPLIFIER SECTION

**Power Output**  
 Front L/R: 170 W/Ch at 6 Ohms, 1 kHz, 10%, 1 Channel Driven,  
 80 W/Ch at 8 Ohms, 20 Hz–20 kHz, 0.08%, 2 Channels Driven, FTC

**Dynamic Power:**  
 160 W (3 Ohms, Front)  
 125 W (4 Ohms, Front)  
 85 W (8 Ohms, Front)

**Input Sensitivity and Impedance:**  
 200 mV rms/47 k-Ohms (Line/Unbalance)  
 3.5 mV rms/47 k-Ohms (Phono MM)

**THD+N (Total Harmonic Distortion + Noise):** 0.08% (20 Hz–20 kHz, Half Power)

**Rated RCA Output Level and Impedance:**  
 1 V rms/470 Ohms (Pre-out/Subwoofer Pre-out)  
 200 mV rms/470 k-Ohms (Zone B Line-out)

**Phono Overload:** 70 mV (MM, 1 kHz, 0.5%)

**Frequency Response:** 10 Hz–100 kHz/+1 dB, -3 dB (Direct Mode)

**Tone Control:**  
 ±10 dB, 20 Hz (Bass)  
 ±10 dB, 20 kHz (Treble)

**Signal-to-Noise Ratio:**  
 106 dB (IHF-A, Line)  
 80 dB (IHF-A, Phono)

**Speaker Impedance:** 4 Ohms–16 Ohms

#### TUNER SECTION

**Tuning Frequency Range:** FM 87.5 MHz–107.9 MHz  
 AM 530 kHz–1,710 kHz

**FM/AM Preset Memory:** 40 Stations

#### GENERAL

**Power Supply:** AC 220 V~, 60 Hz

**Power Consumption:** 460 W

**Standby Power Consumption:** 0.1 W

**Dimensions (W x H x D):** 17 1/8" x 6 7/8" x 14 13/16"  
 (435 x 174 x 376.5 mm)

**Weight:** 21.2 lbs. (9.6 kg)

**CARTON**

**Dimensions (W x H x D):** 22 1/16" x 12" x 18 3/8"  
 (560 x 305 x 467 mm)

**Weight:** 21.2 lbs. (9.6 kg)

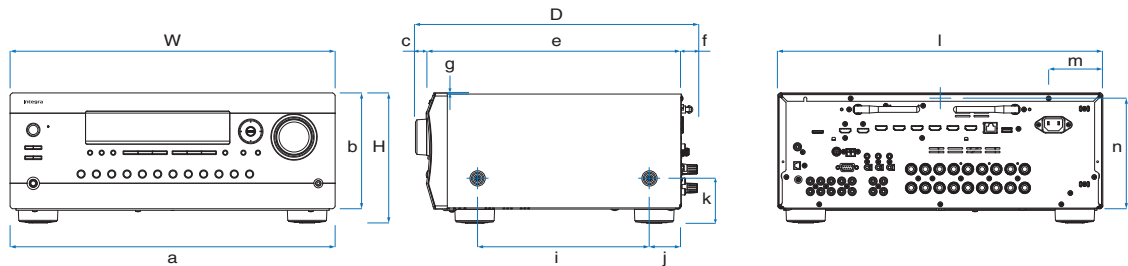

W	H	D	a	b
17 1/8" (435 mm)	6 7/8" (174 mm)	14 13/16" (376.5 mm)	17 1/8" (435 mm)	6 1/8" (155 mm)
c	e	f	g	i
15/16" (24.5 mm)	13" (330.5 mm)	7/8" (21.5 mm)	1/16" (1.5 mm)	9 1/16" (229.5 mm)
j	k	l	m	n
1 11/16" (42.5 mm)	2 3/8" (60.8 mm)	17 1/16" (433 mm)	2 13/16" (71.5 mm)	6 5/8" (167.5 mm)

Due to a policy of continuous product improvement, Integra reserves the right to change specifications and appearance without notice. Dolby, Dolby Atmos, Dolby Surround, Dolby Vision, and the double-D symbol are trademarks of Dolby Laboratories. For DTS patents, see <http://patents.dts.com>. Manufactured under license from DTS Licensing Limited. DTS, the Symbol, DTS and the Symbol together, DTS:X logo, DTS Virtual:X and the DTS Virtual:X logo, DTS Neural:X logo, and Play-Fi are registered trademarks or trademarks of DTS, Inc. © DTS, Inc. All Rights Reserved. The terms HDMI and HDMI High-Definition Multimedia Interface, and the HDMI Logo are trademarks or registered trademarks of HDMI Licensing Administrator, Inc. in the United States and other countries. SONOS is a trademark of SONOS, Inc. The Bluetooth® word mark and logos are owned by the Bluetooth SIG, Inc. AirPlay, Siri, iPad, and iPhone are registered trademarks of Apple Inc. Google, Android, Chromecast built-in, and other related marks are trademarks of Google LLC. Wi-Fi® is a registered trademark of the Wi-Fi Alliance. The Wi-Fi CERTIFIED Logo is a certification mark of the Wi-Fi Alliance. Roon is a trademark of Roon, LLC, registered in the U.S. and other countries. Spotify and the Spotify logo are trademarks of the Spotify Group, registered in the U.S. and other countries. Products displaying the Hi-Res Audio logo conform to the Hi-Res Audio standard as defined by Japan Audio Society. The Hi-Res Audio logo is used under license from Japan Audio Society. PANDORA, the PANDORA logo, and the Pandora trade dress are trademarks or registered trademarks of Pandora Media, Inc. Used with permission. Amazon, Alexa, Amazon Music, and all related logos are trademarks of Amazon.com, Inc. or its affiliates. Qualcomm is a trademark of Qualcomm Incorporated, registered in the United States and other countries. aptX is a trademark of Qualcomm Technologies International, Ltd., registered in the United States and other countries. Qualcomm aptX is a product of Qualcomm Technologies, Inc. and/or its subsidiaries. Integra Remote, Integra Music Control App, Music Optimizer, AccuEQ, and VLSC are registered trademarks or trademarks of Onkyo Home Entertainment Corporation. All other trademarks and registered trademarks are the property of their respective holders.